

4, Tower Mews Lake Hill Sandown, PO36 9EX

£180,000



Offered CHAIN FREE!! This two bedroom end of terrace house is located in the popular seaside town of Sandown. In walking distance to local schools, shops & bus stops. The property consists of a spacious living room, under stairs storage, downstairs WC & Kitchen. Upstairs consists of two good-sized double bedrooms & Family bathroom. Other benefits of the property includes allocated parking and visitor parking, double glazing & gas central heating.

CHAIN FREE!!

2 BEDROOMS

END OF TERRACE HOUSE

CLOSE TO TOWN CENTRE & LOCAL SHOPS

WALKING DISTANCE TO TRANSPORT LINKS

ALLOCATED PARKING

ROOMS

Living Room 14' 7" x 19' 7" (4.45m x 5.98m)
Spacious living area. Double glazed sliding doors leading on to the garden. Double glazed windows to front & side aspect. Radiator.

Under stairs storage 4' 3" x 3' 7" (1.30m x 1.10m)

Kitchen 11' 10" x 10' 10" (3.60m x 3.30m)
Tiled flooring. Gas hob & oven. Sink drainer. Boiler. Double glazed window to side aspect. Room for white goods.

Downstairs WC 2' 9" x 5' 7" (0.84m x 1.69m)
Tiled flooring. Sink & WC. Radiator.

Bedroom 1 14' 7" x 7' 7" (4.45m x 2.32m)
Spacious Double bedroom Carpet flooring. Double glazed window to rear aspect. Radiator.

Bedroom 2 14' 7" x 7' 5" (4.45m x 2.27m)
Carpet flooring. Built-in wardrobe. Double glazed window to front, side & rear aspect. Radiator.

Family Bathroom 3' 5" x 7' 9" (1.03m x 2.37m)
Tiled flooring. Fitted bath & sink. WC. Cupboard.

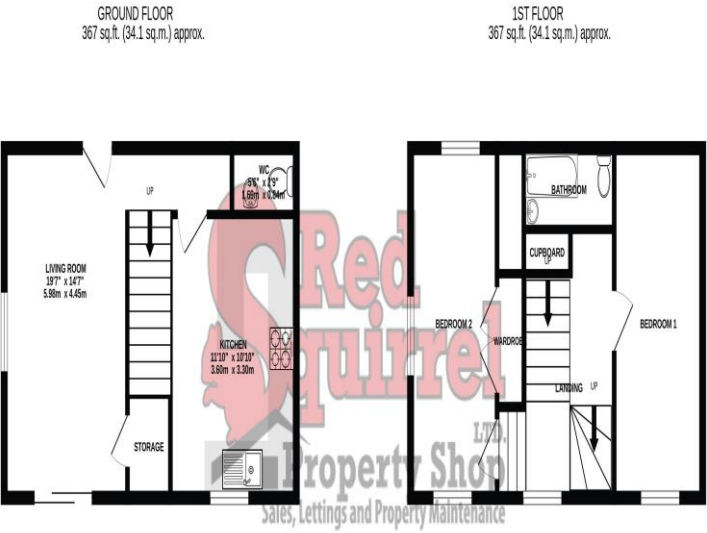

TOTAL FLOOR AREA: 734 sq.ft. (68.1 sq.m.) approx.
Whilst every attempt has been made to ensure the accuracy of the floorplan contained here, measurements of doors, windows, rooms and any other items are approximate and no responsibility is taken for any error, omission or mis-statement. This plan is for illustrative purposes only and should be used as such by any prospective purchaser. The services, systems and appliances shown have not been tested and no guarantee as to their operability or efficiency can be given.
Made with Hertsplan 12023



Address: 4 Tower Mews, Lake Hill, SANDOWN, PO36 9EX
RRN:

